

First Floor

Mezzanine Above the  
iThrive Conference Room

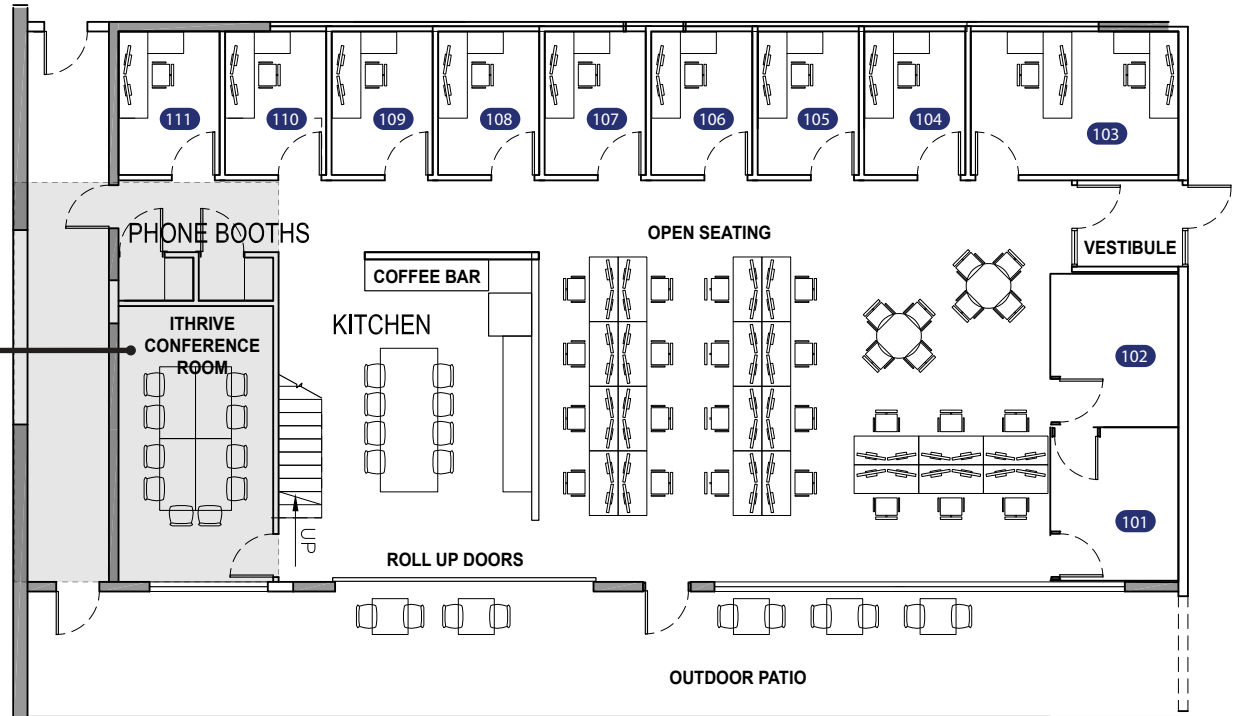
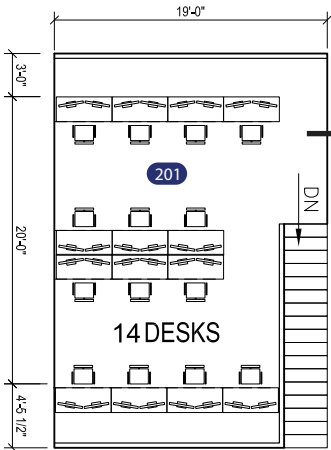

Office Information (approx dimensions)

101	10' X 7'5"	1 - 3 Desks	104	10' x 7'2"	1 - 2 Desks	107	10' x 7'2"	1 - 2 Desks	110	10' x 7'2"	1 - 2 Desks
102	10' x 7'5"	1 - 3 Desks	105	10' x 7'2"	1 - 2 Desks	108	10' x 7'2"	1 - 2 Desks	111	10' x 7'2"	1 - 2 Desks
103	10' x 13'9"	1 - 4 Desks	106	10' x 7'2"	1 - 2 Desks	109	10' x 7'2"	1 - 2 Desks	201	27'5" x 19'	1 - 14 Desks



**MEETING AND AMENITIES CENTER**

- |                        |                                |
|------------------------|--------------------------------|
| <b>12 Seats</b>        | <b>AMCHEM Conference Room</b>  |
| <b>10 Seats</b>        | <b>BASF Conference Room</b>    |
| <b>4 Seats</b>         | <b>Carbide Conference Room</b> |
| <b>6 Seats</b>         | <b>Cognis Conference Room</b>  |
| <b>50 - 100 People</b> | <b>Community Room</b>          |
| <b>5 Seats</b>         | <b>Henkel Conference Room</b>  |
| <b>22 Seats</b>        | <b>Training Room</b>           |
| <b>Rentable</b>        | <b>Wellness Rooms</b>          |
| <b>2 Rooms</b>         | <b>Shower and Locker Rooms</b> |

**Building 4**  
**iThrive**  
**Coworking**

**Building 18**  
**Meeting &**  
**Amenities Center**

