

iThrive

A COWORKING COMMUNITY



135 Greenwood Ave, Suite 400, Wyncote, PA 19095

Membership Amenities



Fully
Furnished



Flexible Office Time
or Private Office



24 / 7
Access



Meeting Room
Credits



Free
Parking



Free Coffee
Beverages & Snacks



Color &
B/W Printing



Enterprise Level
WiFi



Community
Events

Brokers

Get Paid
for referrals!

Brokers need not attend site inspections, but we are happy to have you attend.

New Memberships are paid at the greater of 10% of the first 12 month of membership fees or 5% of the total contract value for membership fees and we continue to pay on Expansions and Renewals. See our Broker Compensation Policy for full terms.



Flexible Memberships with Hybrid, Team and Hoteling Plans

Turnkey Private Office and Configurable Workplace Options for 1 - 25+

Open Space Coworking, Shared Office Time, Meeting and Event Spaces and Virtual Addresses available separately or as add-on to Team Plans

Work out of Multiple Locations

We offer flexible memberships to our uncommon workspaces– so YOU can choose when, where, and how you work. No hidden fees or extra charges, one membership includes enterprise level wifi, black and white printing, coffee, networking opportunities, and the ability to work out of any iThrive location.

Our members:

- Cut unnecessary business costs
- Maximize productivity
- Improve their work-life balance
- Make meaningful connections

Our member agreements are both short term and flexible, with terms that suit your needs. Cancel anytime or upgrade as your company scales.

WYNCOTE LOCATION AMENITIES

Located within 1 block of the Jenkintown Train Station in Wyncote, 145 Greenwood Ave is a converted historic warehouse with high ceilings, exposed stone and wooden beams.

Grab breakfast and handcrafted coffee from Sumatra Cafe or lunch from Mainstreet Pizzeria and Grille next-door. Enjoy the walkable amenities of downtown charm of Jenkintown.

- Onsite Welless/Mothers' Room & Shower Room
- Conference Rooms for 1 - 24
- Outdoor Seating
- Multiple Conference and Zoom Rooms
- Rentable Offices



[Learn Out More About
135 Greenwood Ave
Property by Station Partners](#)

Flexible Office / Hoteling starting at just \$199/month
Dedicated Private Space starting at just \$699/month
Custom Plans Available for Teams
Add-on Coworking Memberships for additional staff

MEMBERSHIP INCLUDES

OFFICE NEEDS

- » Turn-key Space
- » Fast and Secure Wi-Fi Network
- » Enterprise Grade Security
- » Complimentary Office Supplies
- » B&W/color networked printing, scanning and copying
- » Convenient Equipment Lockers For Rent
- » Business Address

FOOD & DRINK

- » Complimentary grind-to-cup coffee and beverage station
- » Complimentary seasonal beer on tap
- » Purified water
- » Fully stocked kitchen with shared refrigerator
- » Close proximity to food establishments including a Brewery, Cafe and Seasonal Events in the Yard.

CONFERENCE & MEETING SPACE

- » Small breakout and phone rooms
- » Multiple Conference Rooms and Polycom voice conferencing

COMMUNITY & GUEST PASSES

- » Access to programming including the monthly Community Lunch, office hours with serial entrepreneurs, various member opportunities to grow and feature their brand
- » Allotted Guest Passes per Membership



KITCHENETTE ZOOM ROOMS

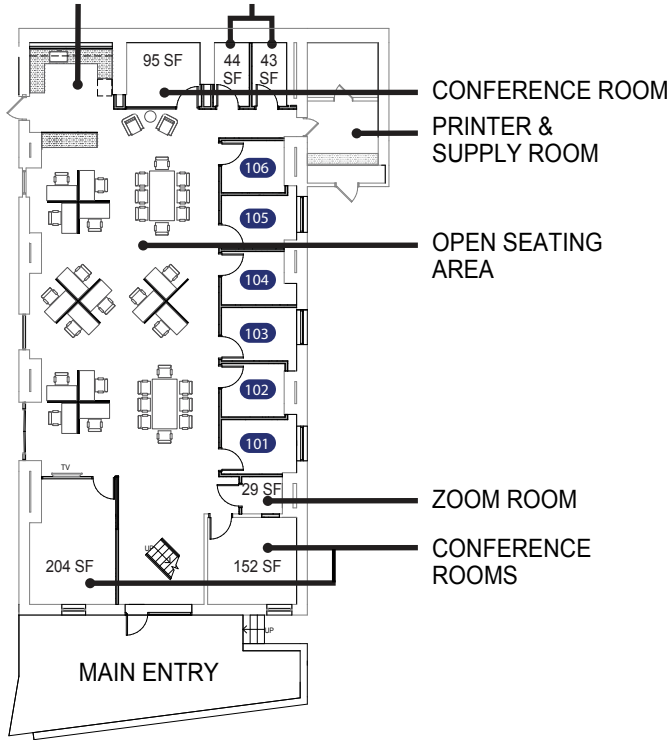

First Floor

CONFERENCE ROOMS

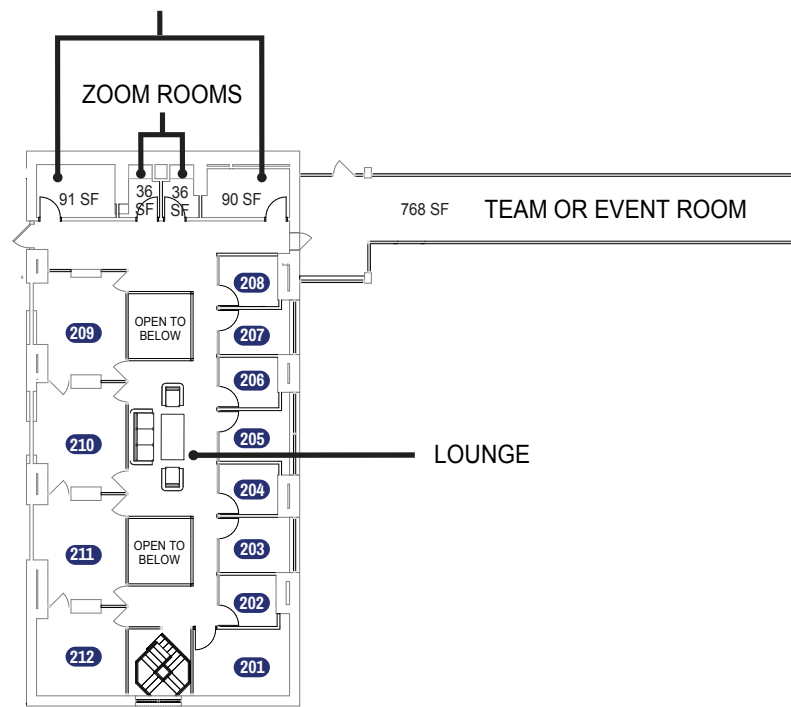

Second Floor

Additional Shared Space in the Building

- Dining / Lounge Areas
- Outdoor Patio / Garden
- Wellness/Mother's Room
- Shower Room

7,280 SF Total

- Walkable to Jenkintown
- Cafes, Restaurants & Train Station Nearby

101	10.5' X 7.5'	1 - 2 people	106	9' x 7.5'	1 - 2 people	205	8' x 10'	1 - 2 people	210	16' x 14'	1 - 4 people
102	9' x 7.5'	1 - 2 people	201	10' x 14'	1 - 4 people	206	8' x 8.5'	1 - 2 people	211	16' x 14'	1 - 4 people
103	10.5' x 7.5'	1 - 2 people	202	8' x 8.5'	1 - 2 people	207	7' x 10'	1 - 2 people	212	13' x 13'	1 - 4 people
104	9.5' x 7.5'	1 - 2 people	203	8' x 10'	1 - 2 people	208	8' x 8.5'	1 - 2 people			
105	10.5' x 7.5'	1 - 2 people	204	8' x 8.5'	1 - 2 people	209	16' x 14'	1 - 4 people			

