

iThrive

A COWORKING COMMUNITY



300 Brookside Ave, Suite 125, Ambler, PA 19002

Membership Amenities



Fully
Furnished



Flexible Office Time
or Private Office



24 / 7
Access



Meeting Room
Credits



Free
Parking



Free Coffee
Beverages & Snacks



Color &
B/W Printing



Enterprise Level
WiFi



Community
Events

Brokers

Get Paid
for referrals!

Brokers need not attend site inspections, but we are happy to have you attend.

New Memberships are paid at the greater of 10% of the first 12 month of membership fees or 5% of the total contract value for membership fees and we continue to pay on Expansions and Renewals. See our Broker Compensation Policy for full terms.

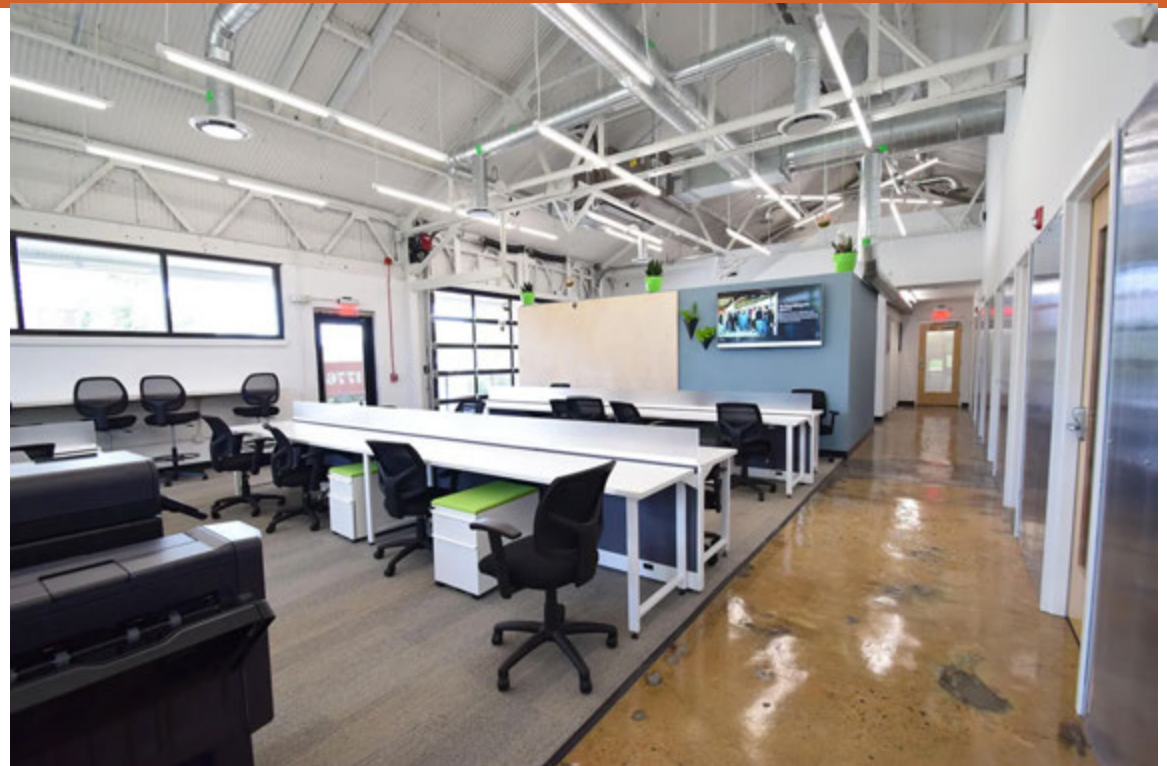

Flexible Memberships with Hybrid, Team and Hoteling Plans

Turnkey Private Office and Configurable Workplace Options for 1 - 25+

Open Space Coworking, Shared Office Time, Meeting and Event Spaces and Virtual Addresses available separately or as add-on to Team Plans

Work out of Multiple Locations

We offer flexible memberships to our uncommon workspaces— so YOU can choose when, where, and how you work. No hidden fees or extra charges, one membership includes enterprise level wifi, black and white printing, coffee, networking opportunities, and the ability to work out of any iThrive location.

Our members:

- Cut unnecessary business costs
- Maximize productivity
- Improve their work-life balance
- Make meaningful connections

Our member agreements are both short term and flexible, with terms that suit your needs. Cancel anytime or upgrade as your company scales.

AMBLER YARDS CAMPUS AMENITIES

- Morning and afternoon shuttle to & from the Ambler Train Station
- Campus onsite fitness room lockers and showers
- Conference Rooms for 1 - 22
- Community Room
- Campus Wide Business Wi-Fi
- Onsite Local Brewery, Dining & Full Gym
- Large Campus Events in the Meadow
- Onsite indoor bike storage
- Outdoor Seating
- Seasonal Events, such as: Food Truck Fridays, yoga and an Outdoor Movie Series



[Learn Out More About Ambler Yards](#)

Flexible Office / Hoteling starting at just \$199/month
Dedicated Private Space starting at just \$699/month
Custom Plans Available for Teams
Add-on Coworking Memberships for additional staff

MEMBERSHIP INCLUDES

OFFICE NEEDS

- » Turn-key Space
- » Fast and Secure Wi-Fi Network
- » Enterprise Grade Security
- » Complimentary Office Supplies
- » B&W/color networked printing, scanning and copying
- » Convenient Equipment Lockers For Rent
- » Business Address

FOOD & DRINK

- » Complimentary grind-to-cup coffee and beverage station
- » Complimentary seasonal beer on tap
- » Purified water
- » Fully stocked kitchen with shared refrigerator
- » Close proximity to food establishments including a Brewery, Cafe and Seasonal Events in the Yard.

CONFERENCE & MEETING SPACE

- » Small breakout and phone rooms
- » Multiple Conference Rooms and Polycom voice conferencing

COMMUNITY & GUEST PASSES

- » Access to programming including the monthly Community Lunch, office hours with serial entrepreneurs, various member opportunities to grow and feature their brand
- » Allotted Guest Passes per Membership

First Floor

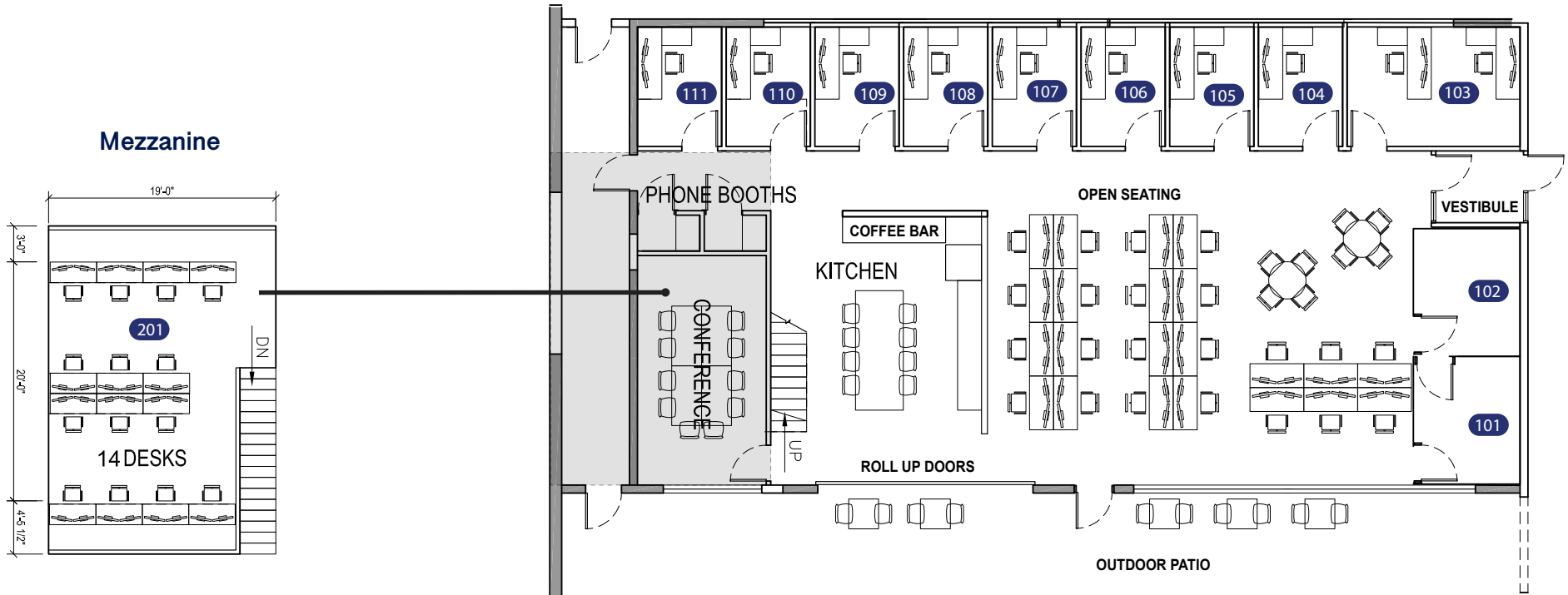

Office Information (approx dimensions)

101	10' X 7'5"	1 - 3 Desks	104	10' x 7'2"	1 - 2 Desks	107	10' x 7'2"	1 - 2 Desks	110	10' x 7'2"	1 - 2 Desks
102	10' x 7'5"	1 - 3 Desks	105	10' x 7'2"	1 - 2 Desks	108	10' x 7'2"	1 - 2 Desks	111	10' x 7'2"	1 - 2 Desks
103	10' x 13'9"	1 - 4 Desks	106	10' x 7'2"	1 - 2 Desks	109	10' x 7'2"	1 - 2 Desks	201	27'5" x 19'	1 - 14 Desks

